

PC12F Flush Diaphragm Pressure Sensor with Flange

Features

- Flange mounting
- Constant current compensation
- Compensation board filled with glue for protection against moisture
- Large size diaphragm, fully welded and sealed, long-term reliability and durability
- For pressure measurement of gas, liquid, steam
- Anti-corrosion diaphragm optional
- Especially suitable for high temperature viscous liquids

Applications and industries

■ Process control used in petroleum, chemical industry, metallurgy, electric power, food, papermaking, medicine, machinery manufacturing, scientific experiments and aviation and military industries.

Notes:

- 1 Do not touch the diaphragm with hard objects, which may cause damage to the diaphragm.
- 2 Please read the Instruction Manual of the product carefully before installation and check the relevant information of the product.
- 3 Strictly follow the wiring method for wiring, otherwise it may cause product damage or other potential faults.
- 4 Misuse of the product may cause danger or personal injury.



Product overview

PC12F flush diaphragm pressure sensor with flange is a flush diaphragm product that meets the flange installation requirements of customers. This product uses imported diffused silicon pressure sensitive elements, and after long-term aging and stability screening, the product performance is stable and reliable. It is an excellent choice for field use and production of pressure transmitters.

PC12F flush diaphragm pressure sensor with flange adopts the international standard flange interface standard, allowing for user-friendly flange installation methods. As the force diaphragm is exposed to directly sense pressure, it is easy to clean and can meet requirements for harsh conditions such as moisture and water resistance. This series of products are widely used in industrial process control, petroleum, chemical industry, metallurgy, and other media containing particulate and viscous substances.

Notes:

- 1 Do not misuse documentation.
- 2 The information presented in this product sheet is for reference only. Do not use this document as a product installation guide.
- 3 Complete installation, operation, and maintenance information is provided in the instructions of the product.
- 4 Misuse of the product may cause danger or personal injury.

Performance parameters

Pressure range	0~35kPa...6MPa
Pressure reference	Gauge pressure Absolute pressure Sealed gauge pressure
Power supply	1.5mA excitation
Non-linearity	±0.25%FS(BFSL,@25±5℃)
Temperature drift	±1.5%FS
Compensation temp.	-10℃~70℃
Operating temp.	-40℃~100℃
Storage temp.	-40℃~85℃
Insulation resistance	≥200MΩ/250VDC
Overload pressure	150%FS
Long-term stability	±0.2%FS/Year
Diaphragm material	316L(316L Sprayed with PTFE、Hastelloy C、Tantalum)
Oil filling	Silicon oil
Electrical connection	M25×1, M27×2
Process connection	DN25、DN50、DN80
Weight	5kg (DN50)

Outline dimension

Dimension drawing (Take DN50 as an example)

In mm

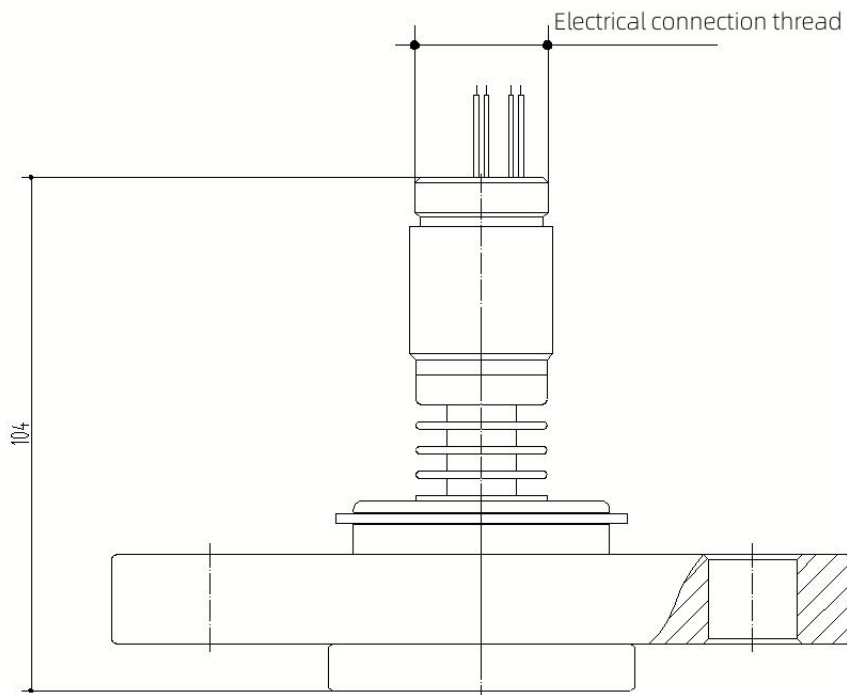



Ordering tips

1. Please ensure the compatibility between the measured medium and the contacting part of the product when placing an order.
2. If you have special requirements for product appearance and performance parameters, our company can provide customization.

Contact us

Nanjing Wotian Technology Co., Ltd.

Website: www.wtsensor.com

Add: 5 Wenying Road, Binjiang Development Zone, Nanjing, 211161, China

E-mail: dr@wtsensor.com