

PCM103 Pressure Transmitter

Features

- Compact structure and exquisite appearance
- Digital circuit processing
- High accuracy and high stability
- Strong anti-interference and good long-term stability
- Small size, light weight, easy to install and use
- Wide pressure ranges
- Suitable for mass production, economically reliable

Applications

- Industrial Control Equipment
- Data Acquisition System
- Construction machinery

Notes:

- 1 Do not touch the diaphragm with hard objects, which may cause damage to the diaphragm.
- 2 Please read the Instruction Manual of the product carefully before installation and check the relevant information of the product.
- 3 Strictly follow the wiring method for wiring, otherwise it may cause product damage or other potential faults.
- 4 Misuse of the product may cause danger or personal injury.



Product overview

The compact pressure transmitter adopts a glass micro melt sensor, which is suitable for high pressure overload and can effectively resist instantaneous pressure impact. It can measure fluid media with a small amount of impurities. The built-in digital processing circuit converts the sensor millivolt signal into standard voltage and current signal output, with various structural forms and output forms, meeting the vast majority of application requirements.

Notes:

- 1 Do not misuse documentation.
- 2 The information presented in this product sheet is for reference only. Do not use this document as a product installation guide.
- 3 Complete installation, operation, and maintenance information is provided in the instructions of the product.
- 4 Misuse of the product may cause danger or personal injury.

Performance parameters

Pressure range	-0.1MPa...1MPa...100MPa
Pressure reference	Gauge pressure, Sealed gauge pressure
Power Supply	5VDC/3.3VDC/9~36VDC/12~36V
Output Signal	0.5~4.5V、0~5V、0.5~2.5V、1~5V、0~10V、4~20mA
Accuracy	±0.5%FS
Operating temperature	-20~125℃
Storage temperature	-40~125℃
Overpressure	200%FS(>60MPa,150%FS)
Mechanical vibration	Sinusoidal curve: 20g (25Hz-2kHz)
Long term stability	±0.2%FS/year
Insulation	≥100MΩ/250VDC
Protection	IP65/IP67
Pressure sensor material	PH17-4

Note:

1. Minimum range is 1MPa, can produce 0~1MPa or -0.1~1MPa products.
2. Do not touch the glass micro melt sensor with hard objects, which may cause damage to the sensor.

External dimensions and wiring definitions:

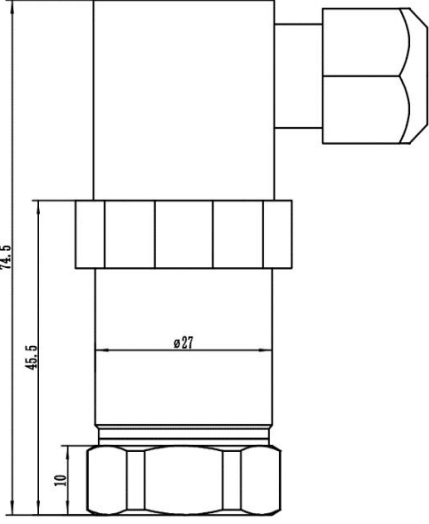
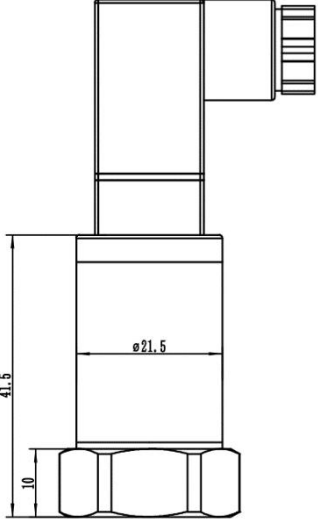
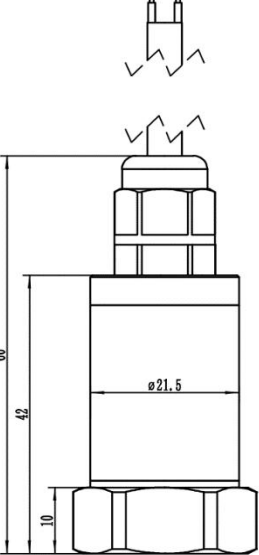
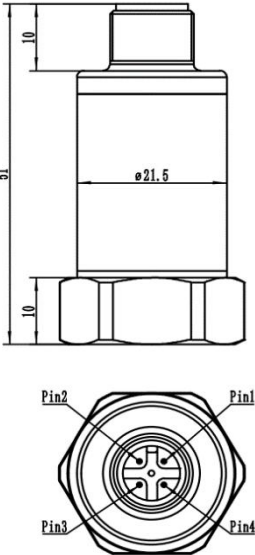
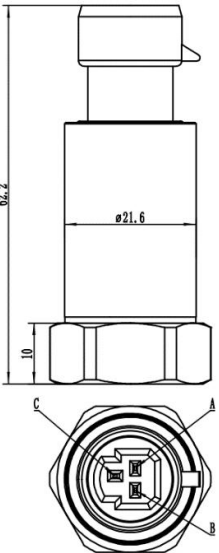
DIN43650	Mini 4 Pin	Cable outlet
		
M12	Packard	
		

	DIN43650&Mini 4 Pin	M12	Cable outlet	Packard
Wiring definitions (Current)	Pin1: Power supply (Red wire) Pin2: Output (Black wire)	Pin1:Power supply (Brown wire) Pin3: Output (Blue wire)	Red: Power supply Black: Output	B:Power supply A:Output
Wiring definitions (Voltage)	Pin1: Power supply+ (Red wire) Pin2: Power supply- (Black wire) Pin3: Output (Green wire)	Pin1:Power supply+ (Brown wire) Pin2: Output (white wire) Pin3:Power supply- (blue wire)	Red: Power supply+ Black: Power supply- Green: Output	B:Power supply+ A:Power supply- C:Output

Thread Connection:

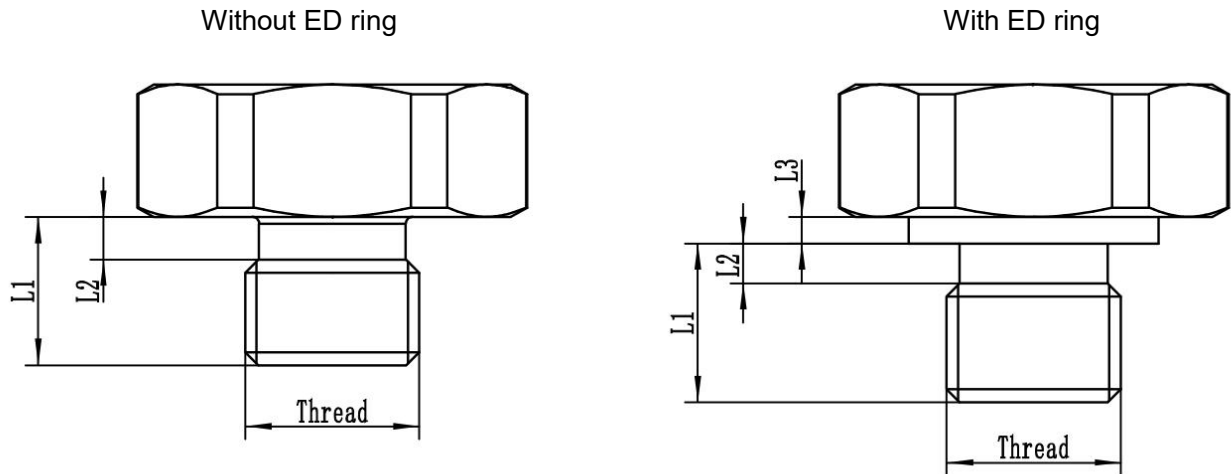

Note: DIN43650 adopts HEX27, other dimension please see the following table

Basic dimension and thread code									
Thread	Without ED ring				With ED ring				
	L1	L2	Hexagon	Thread code	L1	L2	L3	Hexagon	Thread code
M10X1	9.5	2	HEX24	T1	8	2	1.5	HEX24	T1-E
M12X1.5	11	3	HEX24	T2	12	3	2	HEX24	T2-E
M14X1.5	11	3	HEX24	T3	12	3	2	HEX24	T3-E
M16X1.5	12.5	3	HEX24	T4	12	3	2	HEX24	T4-E
M20X1.5	14	3	HEX24	T5	14	3	2.5	HEX27	T5-E
G1/8	7.6	1.8	HEX24	T6	8	2	1.5	HEX24	T6-E
G1/4	11.2	3.2	HEX24	T7	12	3	2	HEX24	T7-E
G1/2	14.5	3.2	HEX24	T8	14	4	3	HEX27	T8-E
NPT1/4	12	14	HEX24	T9	/	/	/		
NPT1/2	14	16	HEX24	T10	/	/	/		
R1/4	12	14	HEX24	T11	/	/	/		
R1/2	14	16	HEX24	T12	/	/	/		

How to order

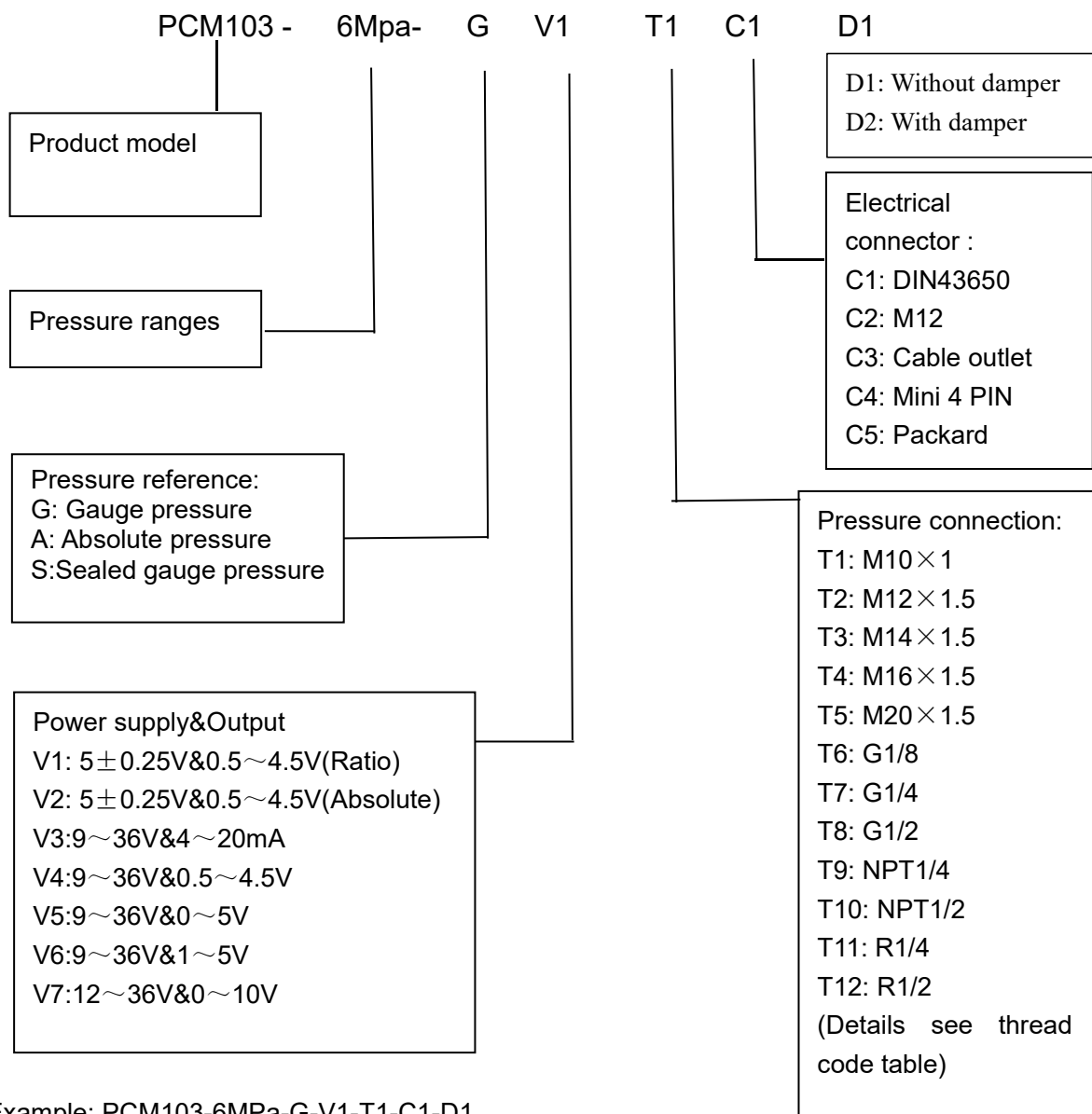

Example: PCM103-6MPa-G-V1-T1-C1-D1

The pressure model is PCM103, pressure range: 0-6MPa, pressure reference: Gauge pressure, Power supply: $5 \pm 0.25V$, Output signal: $0.5 \sim 4.5V$ (Ratio), Pressure connection: $M10 \times 1$ Electrical connector :DIN43650, without damper.

Ordering tips

1. Ensure compatibility between measured media and contacting part of product.
2. For special requirements on the appearance and performance parameters, customization is available.
3. Over 100MPa need special mounting method, please contact with sales about specific sealing method.



Wotian reserves the right to make any change in this publication without notice. The information provided is believed to be accurate and reliable as of this product sheet.

Contact us

Nanjing Wotian Technology Co.,Ltd.

Website: www.wtsensor.com

Add: 5 Wenying Road, Binjiang Development Zone, Nanjing, 211161, China

E-mail: dr@wtsensor.com