

PCM161 Low Differential Pressure Transducer

Features

- Up to 15 PSI Proof Pressure on all

Ranges

- Miswiring Full Protection
- Unsymmetrical Bidirectional

Pressure Ranges

- True Zero Output for Voltage Unit

Applications and industries

- HVAC and VAV Control
- Clean Room and Isolation Rooms
- Duct Static Pressure Measurement
- Draft Control and Fume Hood Control
- Furnace Air Flow Control
- Power Plant Air Flow Monitor and Control
- CE RoHS Compliant

Notes:

- Please read the Instruction Manual of the product carefully before installation and check the relevant information of the product.
- Misuse of the product may cause danger or personal injury.



Product Overview:

The PCM161 Series are low range differential pressure transducers and transmitters in HVAC building automation, high accuracy pharmaceutical and health care facilities. The patented variable capacitance pressure sensor is constructed by stainless steel and glass, no glue or other organics. That provides excellent performance, corrosion resistance and long-term stability, the Model PCM161 delivers reliable measurements below 0.05 inches of water.

Notes:

- Do not misuse documentation.
- The information presented in this product sheet is for reference only. Do not use this document as a product installation guide.
- Complete installation, operation, and maintenance information is provided in the instructions of the product.
- Misuse of the product may cause danger or personal injury.



Technical Parameters:

Accuracy	$\pm 0.60\%FS$	$\pm 0.40\%FS$	$\pm 0.25\%FS$
Non-Linearity (BFSL)	$\pm 0.55\%FS$	$\pm 0.37\%FS$	$\pm 0.24\%FS$
Hysteresis	$\pm 0.20\%FS$	$\pm 0.10\%FS$	$\pm 0.05\%FS$
Non-repeatability	$\pm 0.10\%FS$	$\pm 0.10\%FS$	$\pm 0.05\%FS$
Thermal Effects: Zero/Span Shift	$\pm 0.03\%FS$	$\pm 0.02\%FS$	$\pm 0.015\%FS$
Compensated Flange	40 to 170° (4-77°C)		
Maximum Line Pressure	15PSI (10KPa)		
Overpressure	15PSI (100KPa) in positive or Negative Direction for all Ranges		
Stability	$\pm 0.5\%FS/YR$		
Warm-up Time	5 Seconds to meet specification		
Position Effect	Each unit is calibrated in the vertical position. For best accuracy, adjust zero of the unit if it is mounted in other position. It is not necessary to adjust the sensitivity.		

Environmental Data and Physical Description

Operating Temperature	0-170° F(-18 to 77°C)
Storage Temperature	-40 to 185° F(-40 to 85°C)
Electrical Termination	Terminal Strip
Pressure Fittings	3/16" O.D barbed brass for 1/8" I.D. Push-on tubing(standard) 6.5mm and 8mm O.D barbed brass (optional)
Zero & Span Adjustment	Accessible under the small cap
Pressure Media	Typically air or similar non-conducting gases
Enclosure	Stainless Steel and PC_ABS Alloy, 94V-0Rated
Weight	4.0 OZ/113g
Installation	See Diagram 1 for outline and dimensions

Electrical Data(Voltage)

Circuit	3-wire (+EXC,-EXC, OUTPUT) Protected from miswiring
Excitation	12-32VDC/ 12-30VAC
Output	0-5VDC, 0-10VDC
Output Impedance	$\leq 5.0OHMS$

Electrical Data(Current)

Circuit	2-wire (+EXC,-EXC) Protected from miswiring
Excitation	12-32VDC
Output	4-20Ma
Bidirectional Output at Zero	12mA as standard
External Load	0-1000OHM

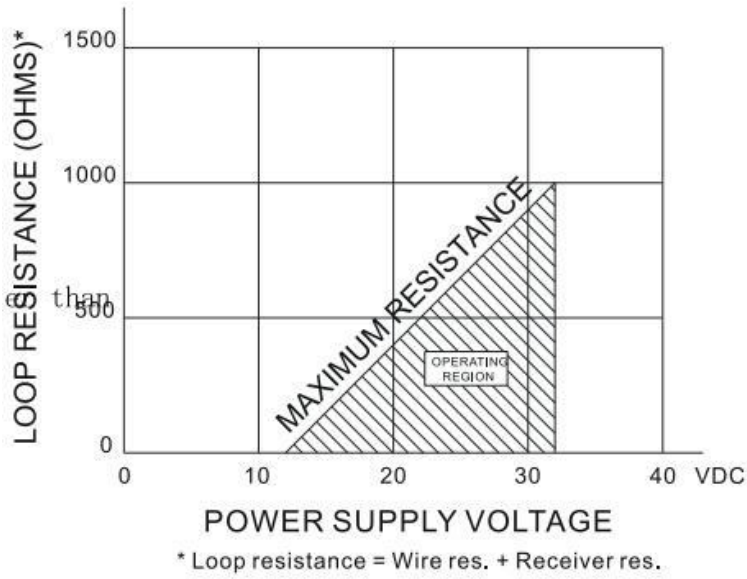
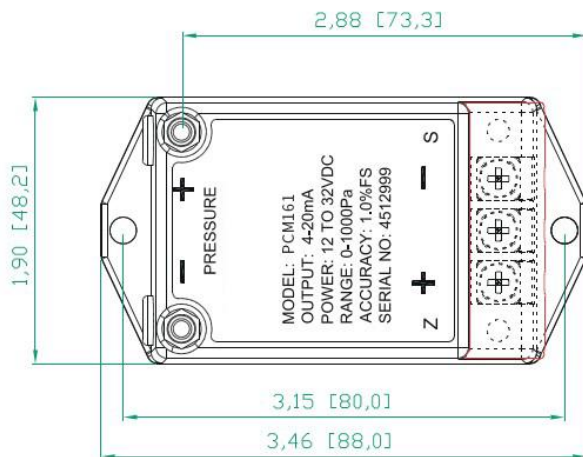

Diagram 2

Drawing :



DIMENSIONS ARE IN: INCH [mm]

* A UNIT WITH CURRENT OUTPUT AND 3/16" PRESSURE FITTINGS IS SHOWN.

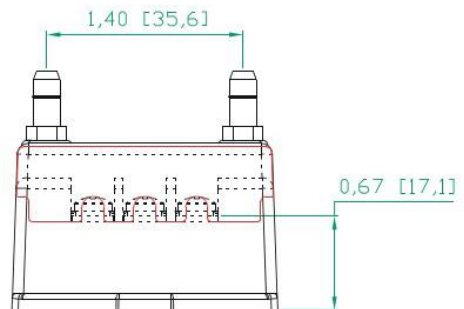
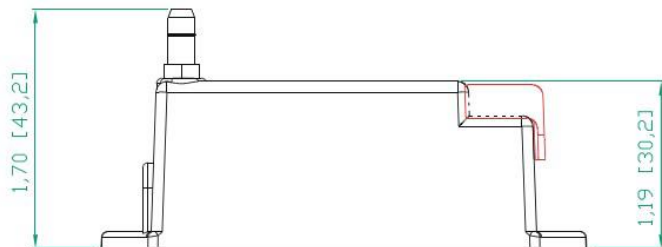

Diagram 1



How to order:

1	6	1						
Model	Unit	Range	Pressure Type	Output	Accuracy	Certificate	Pressure Fitting	
PCM161	P: Pascal W: in. W.C.	NNNN	Differential D: Unidirectional B: Bidirectional	A: 4-20mA B: 0-5VDC C: 0-10VDC	6: 0.6%FS 4: 0.4%FS 2: 0.25%FS	Y (with) N (without)	A: 3/16" B: 8mm E: 6.5mm (Barbed Brass)	
Pressure Unit/Range/Type								
in. W.C. (Unidirectional)			in. W.C. (Bidirectional)		Pascal (Unidirectional)		Pascal (Bidirectional)	
W00R1D=0-0.1 in. W.C.			W0R05B= ± 0.05 in. W.C.		P0025D=0-25 Pa		P0010B= ± 10 Pa	
W0R25D=0-0.25 in. W.C.			W00R1B= ± 0.1 in. W.C.		P0050D=0-50 Pa		P0025B= ± 25 Pa	
W00R5D=0-0.5 in. W.C.			W0R25B= ± 0.25 in. W.C.		P0100D=0-100 Pa		P0050B= ± 50 Pa	
W0001D=0-1 in. W.C.			W00R5B= ± 0.5 in. W.C.		P0250D=0-250 Pa		P0100B= ± 100 Pa	
W02R5D=0-2.5 in. W.C.			W0001B= ± 1 in. W.C.		P0500D=0-500 Pa		P0250B= ± 250 Pa	
W0005D=0-5 in. W.C.			W02R5B= ± 2.5 in. W.C.		P1000D=0-1000 Pa		P0500B= ± 500 Pa	
W0010D=0-10 in. W.C.			W0005B= ± 5 in. W.C.		P2500D=0-2500 Pa		P1000B= ± 1000 Pa	
W0025D=0-25 in. W.C.			W0010B= ± 10 in. W.C.		P5000D=0-5000 Pa		P2500B= ± 2500 Pa	
W0050D=0-50 in. W.C.			W0025B= ± 25 in. W.C.		P100CD=0-10000 Pa		P5000B= ± 5000 Pa	
W0100D=0-100 in. W.C.			W0050B= ± 50 in. W.C.		P250CD=0-25000 Pa		P100CB= ± 10000 Pa	

Contact us

Nanjing Wotian Technology Co.,Ltd.

Website: www.wtsensor.com

Add: 5 Wenyong Road, Binjiang Development Zone, Nanjing, 211161, China